



Installation Instructions

1994-1996 Door Panel Compartment Lid Hinge

Instructions for transferring the Compartment Lid Hinge from the old panel to the new panel.

1. Remove the original door panel from door.



2. Place the old door panel face down and remove the two screws on back of the panel that secures the hinge to the panel.



3. Remove the Compartment Lid from the old panel. Then remove the four screws from the underside of the compartment lid. Separate the hinge from the old Compartment Lid.

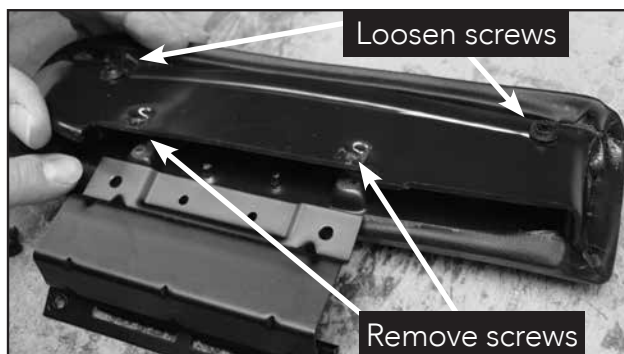

4. Remove the two screws from the new lid that will hold the hinge. Loosen the top two screws.



5. Place hinge in position over the alignment pins and fasten all four screws.



6. Use two screws to fasten the Compartment Lid onto the new panel.

100 Classic Car Drive, Reedsville, PA 17084
(877) 4AAAdirect or (877) 422-2347 • Fax: 717-667-3174
Email: customerservice@AAAdirect.com • www.AAAdirect.com

