



Installation Instructions

1967 Bolt On Wheels

Important Notice: In addition to the items supplied with your wheel set, the following items will be needed to install your Bolt-On Wheels:



Tools Needed

- | | | |
|-------------------|----------------------|--|
| 1. Socket set | 4. Jack Stands | 7. Rubber Mallet or non-marking hammer |
| 2. Nut driver set | 5. Jack & Lug wrench | |
| 3. Wrenches | 6. Magic marker | |

1. Inspect your Bolt-On Wheel Set. Each set should consist of the following:

- 4 Bolt-On Wheels
- 4 Starburst Wheel Centers
- 4 Center Cap Emblems
- 4 Starburst Retaining Rings
- 16 Wheel Clips
- 48 Small Screws
- 20 Large Bolts
- 20 Lugnuts

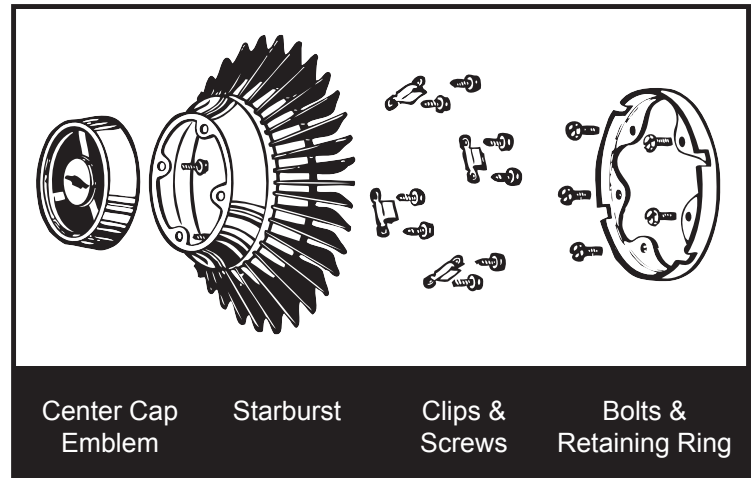

If your set does not contain the correct assortment of pieces, contact the Auto Accessories of America Authorized Dealer where purchased for replacement of necessary items.

2: Have your tires installed on the Bolt-On Wheels and have the Bolt-On Wheel/Tire assemblies properly balanced prior to installation on the vehicle. An unbalanced or improperly balanced Bolt-On Wheel/Tire assembly can cause excessive vibration and contribute to premature tire and suspension wear. Take your Bolt-On Wheels to a reputable dealer for tire installation. Bolt-On Wheels represent a considerable investment in your automobile and can easily be marred by someone not familiar with aluminum wheels.

3: Install the retaining rings on the wheels by aligning the 5 mounting holes in the rings with the 5 corresponding holes in the wheel and using the large bolts to secure the ring to the wheel. Install only 2 bolts in each ring, on opposite sides, at this time.

4: Install 4 wheel clips on each starburst by aligning the mounting tabs on the ends of each clip with the two mounting holes found at four locations around the perimeter of the starburst. Note that the clips have a long side and short side. The clip must be installed so the long side of the clip

Continued on next page

100 Classic Car Drive, Reedsville, PA 17084
(877) 4AAAdirect or (877) 422-2347 • Fax: 717-667-3174

Email: customerservice@AAAdirect.com • www.AAAdirect.com



is toward the center of the starburst. If the clips are not installed correctly, it will be virtually impossible to remove the starbursts from the wheels without causing damage to both. Use the small screws to secure each clip to the starburst.

5: Attach the center cap emblems to each starburst by aligning the 4 holes in the back of each emblem with the holes in the 4 mounting tabs on the starburst. Secure the emblem in place with the small screws.

6: Before installing the wheels on the car, pre-fit a starburst on each wheel to make sure the retaining ring is indexed correctly. If the retaining ring is not indexed correctly on the wheel, the fins on the starburst will not fit between the fins on the wheel.

Notice there are 4 posts protruding from the back of the starbursts. These are alignment posts. These posts align with the 4 notches cut into the outer edge of the retaining ring. As you align the posts and notches, the fins of the starburst should fall between the fins of the wheel and the wheel clips should contact the edge of the retaining ring.

If the starburst doesn't align, rotate the starburst one set of alignment notches at a time in a clockwise direction. Try all 4 possible positions.

If the starburst still doesn't align properly, it will be necessary to remove the retaining ring and rotate it one set of screw holes in a clockwise direction. Put only 2 screws back into the ring and try the alignment of the starburst again. Try all 4 possible positions of the starburst on the retaining ring. If the starburst still doesn't align, remove the 2 screws holding the ring and rotate the ring another set of screw holes. Replace the 2 screws and try the starburst again. Repeat the process until the starburst aligns properly on the wheel.

Auto Accessories of America, Inc. Policy: 30 Day Limited Warranty — All products are warranted to be free of defects in workmanship and materials for a period of 30 days from invoice shipment date. Auto Accessories of America, Inc. cannot ensure that these directions will be followed completely and/or correctly. Therefore, THE OBLIGATION OF AUTO ACCESSORIES OF AMERICA, INC., WARRANTOR, IS LIMITED TO REPLACEMENT OF DEFECTIVE MERCHANDISE ONLY. THERE ARE NO OTHER WARRANTIES, EITHER EXPRESSED OR IMPLIED. WARRANTOR SHALL NOT BE LIABLE FOR ANY INCIDENTAL OR CONSEQUENTIAL DAMAGES INCLUDING, BUT NOT NECESSARILY LIMITED TO, LOSSES CAUSED BY DELAY IN THE INSTALLATION OF WARRANTOR'S PRODUCTS, OR FOR THE TRANSPORTATION OR ANY OTHER CHARGE INCURRED IN THE REPAIR OR REPLACEMENT OF A DEFECTIVE ITEM, OR REMOVAL OR USE OF THIS MERCHANDISE.

Once the starburst is aligned on the wheel, mark an alignment post and its matching notch on the retaining ring with the magic marker to facilitate quick final assembly. Install all 5 mounting screws in the retaining ring and tighten securely. Torque to 35-50 in. lbs. Perform these operations on all 4 wheels. Be patient and methodical. The starbursts will align.

7: Jack up the car according to the manufacturer's instructions. Use jack stands to support the vehicle. Never work under a car that is supported only by a jack.

8: Place the Bolt-On Wheel / Tire Assembly on the vehicle by aligning the wheel studs with the holes in the Bolt-On Wheel. Using the Bolt-On Wheel Lugnuts supplied with your wheel set, install a lugnut on each wheel stud. Torque each lugnut to 70-85 lbs. ft.

9: Install the starburst assembly on the wheel by aligning the previously indexed alignment post and notch on the retaining ring and tapping the starburst into place with the heel of your hand.

Be sure all of the clips contact the retaining ring as you install the starburst. It may be necessary to use a rubber mallet or similar non-marking, soft-faced hammer to seat the starburst assembly fully on the retaining ring.

Repeat these procedures for the remaining wheels. In the event it is necessary to remove the wheels from the vehicle, it will be necessary to first remove the starburst assembly. This is most easily accomplished by using a large, flat-bladed screwdriver as a pry bar and gently prying the starburst away from the wheel. Keep the screwdriver as close to the center of the wheel as possible to avoid marring the wheel in a visible area and never pry on the fins of the starburst.

100 Classic Car Drive, Reedsville, PA 17084
(877) 4AAAdirect or (877) 422-2347 • Fax: 717-667-3174

Email: customerservice@AAAdirect.com • www.AAAdirect.com

