



## Installation Instructions

# #43954 1997-2013 Seat Conversion Kit to fit 1968-1982 Corvettes

The CA Seat Conversion Kit #43954 makes it possible to install 1997 through 2013 (C5/C6) Corvette seats in a classic 1968 through 1982 (C3) Corvette utilizing the original seat tracks and mounting points. The seats are not included as part of this kit and must be acquired separately. **NOTE:** The power features built into the C5/C6 seats will not be functional after the installation of this conversion kit. **NOTE:** Due to the C5/C6 seat bottom height difference from the C3 seat, head height clearance will be affected.



### Tools Required

- |                              |                          |
|------------------------------|--------------------------|
| 1. 1/2" Wrench               | 6. Flat Head Screwdriver |
| 2. 1/2" Socket               | 7. Pliers                |
| 3. 3/8" Socket               | 8. Wire Cutters          |
| 4. Ratchet                   | 9. Hog Ring Pliers       |
| 5. Phillips Head Screwdriver | 10. Hog Rings            |



### Verify Components

- |                  |                             |
|------------------|-----------------------------|
| 2- Seat Brackets | 8- 5/16"-18 x 7/8" Bolts    |
| 8- 1/4" Spacers  | 8- 5/16"-18 x 1-1/4" Bolts  |
| 8- 1/2" Spacers  | 16- 5/16"-18 Thin Lock nuts |

## Removing C3 Seats from the Car

1. Locate and remove the four mounting seat bolts (two bolts in front and two bolts in rear) that secure the passenger side seat tracks to the floor using a 1/2" socket/ratchet. See figures 1 and 2.
2. Remove the seat from the car by folding the seat forward.  
**NOTE: Removing the t-tops, hard top or lowering the convertible top may help with seat removal.**
3. Repeat the previous steps for the other seat.



FIGURE 1

## Removing the Seat Tracks from C3 Seats

1. Locate and remove the 4 mounting bolts that secure the seat tracks to the seat frame using a 3/8" socket/ratchet.  
**NOTE: The bolts are located in between the seat tracks.**
2. Set the seat tracks aside for later install.
3. Repeat the previous steps for the other seat.



FIGURE 2

100 Classic Car Drive, Reedsville, PA 17084

(877) 4AAAdirect or (877) 422-2347 • Fax: 717-667-3174

Email: customerservice@AAAdirect.com • www.AAAdirect.com



## Removing the Seat Tracks from C5/C6 Seats

1. On one of the C5/C6 seats, remove seat back adjustment handle by removing the C-Clip with a screwdriver.
2. Remove the two Phillips head screws securing the Control Bezel & unplugging the wiring harness once the bezel is loose.
3. Locate and remove the hog rings that hold the rear seat cover flap to the support. Also locate and remove the hog rings at the hinge area.
4. Untie the drawstring that tightens the seat cover and remove the seat cover and cushion from the frame.
5. Locate and remove the four mounting nuts from the original C5/C6 seat tracks using a 1/2" socket/ratchet. See figure 3.
6. Remove the wiring controls and disconnect or cut the air lines for the lumbar support. Remove the seat frame from the track assembly.
7. Repeat the previous steps for the other seat.

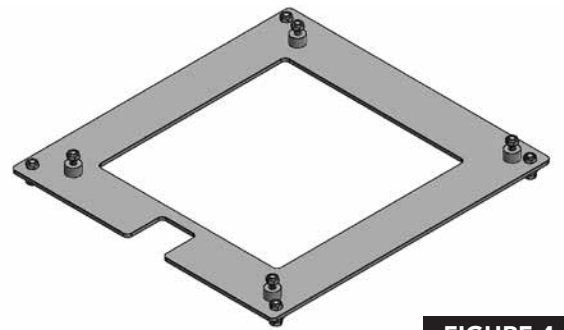

## Installing the Seat Conversion Bracket



**Note:** The notch in the Seat Bracket should always be positioned over the seat track with adjuster handle. See figure 4.

1. Attach the bracket to your C5/C6 seat frame by inserting the 5/16"-18 x 1-1/4" bolts up through the inner holes in the seat bracket, place a 1/2" spacer over each bolt, then insert the bolts into the mounting holes on the seat frame. Secure the bolts with the supplied 5/16"-18 Nyloc nuts. Torque nuts to 180 in-lbs. See figure 5A.
2. Next bolt the C3 seat tracks to the seat bracket by inserting the 5/16"-18 x 7/8" bolts through the seat tracks. Put a 1/4" spacer over each bolt and then through seat bracket. With a 1/2" socket and wrench secure the bolts using the supplied 5/16"-18 Nyloc nuts. Torque nuts to 180 in-lbs. Figure 5B.
3. To reinstall seat cover, reverse the steps in previous section.
4. Repeat the previous steps for the other seat.

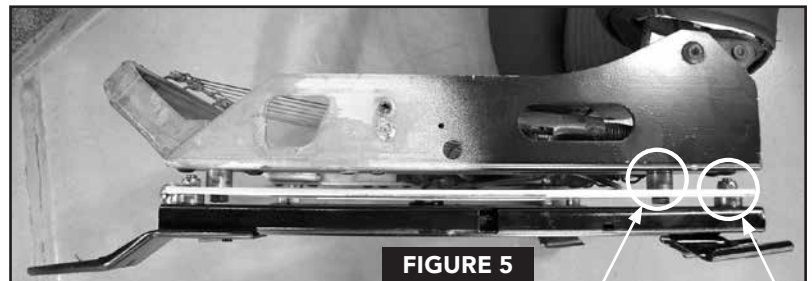

5A

5B

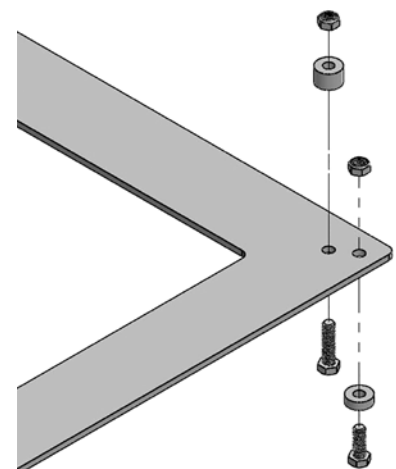

## Installing C5/C6 Seats Into the Car

1. To mount the driver seat back in the car align the four mounting holes and reinstall the front and rear seat mounting bolts. Torque bolts to 180 in-lbs.
2. Repeat the previous steps for the passenger side seat.